



All Saints' Church, Elm; Community Hub Initial Options

Date 16 December 2024

r h partnership architects

www.rhpartnership.co.uk

Contact: Katherine Robinson
Email: katherine.robinson@rhpartnership.co.uk
Tel: 01223 316309

Report Ref: P1535
Revision: rev 01
Date: 16/12/2024
Checked: HA



Existing Layout

Existing Plan

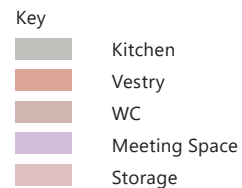
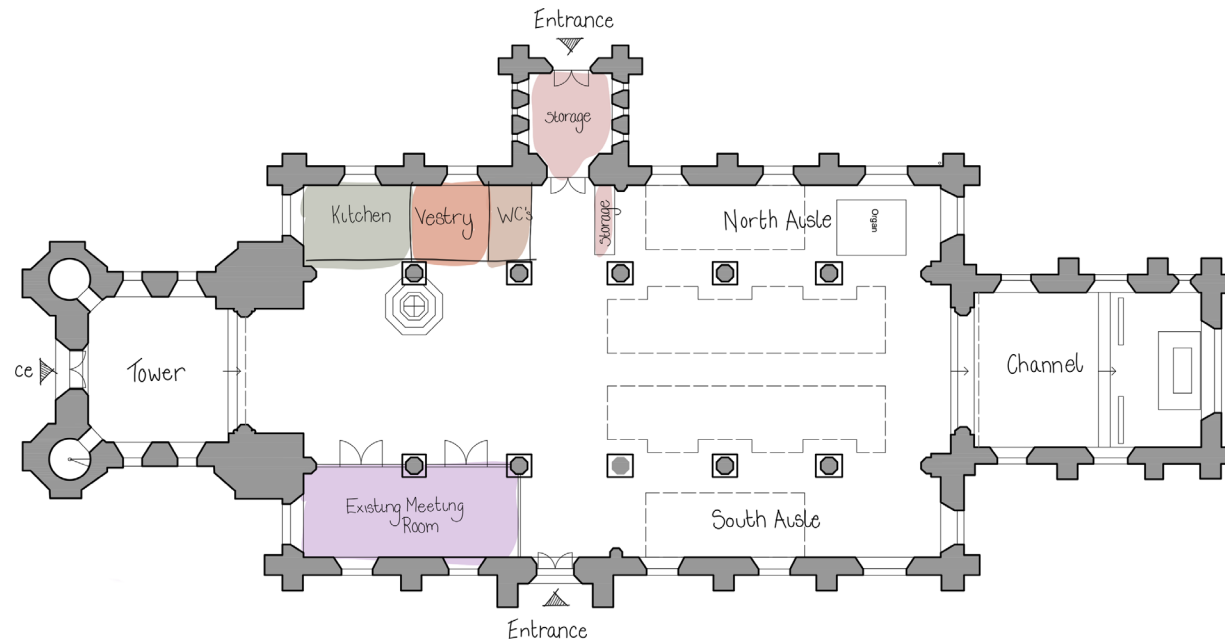

Constraints

- Existing kitchen facilities are not sufficient for perceived need. They are also shut away and are therefore disconnected from the space.
- Existing WC and Vestry are functional but could be improved as part of looking at opportunities for the kitchen facilities.
- North Porch currently used as a storage area and could potentially be put to better use.
- Lack of storage within the church
- Leaving South door open to invite community in means that heat is easily lost and church feels cold and less inviting.
- West end of the church is large and could be better used hence the need for these initial options.

Opportunities

- Larger and more open kitchen space that is inviting and serves the needs of the church better. Possibility for flexibility to allow for different uses of the space.
- Additional WCs (number TBC) will require new drainage - current trench arch system will not be able to accommodate.
- Potential for North Porch to be given a function rather than just as overflow storage.
- Additional storage to address current and future needs.
- Ability for the west end of the church to become a flexible and functional space to serve the local community.
- Potential to create lobby around the South door to help heat to be better retained within the space.
- Potential to upgrade existing space heating and lighting to better serve future community use.
- Possible relocation of font to allow for greater flexibility of west end.

Initial Interventions

Sketch Layout

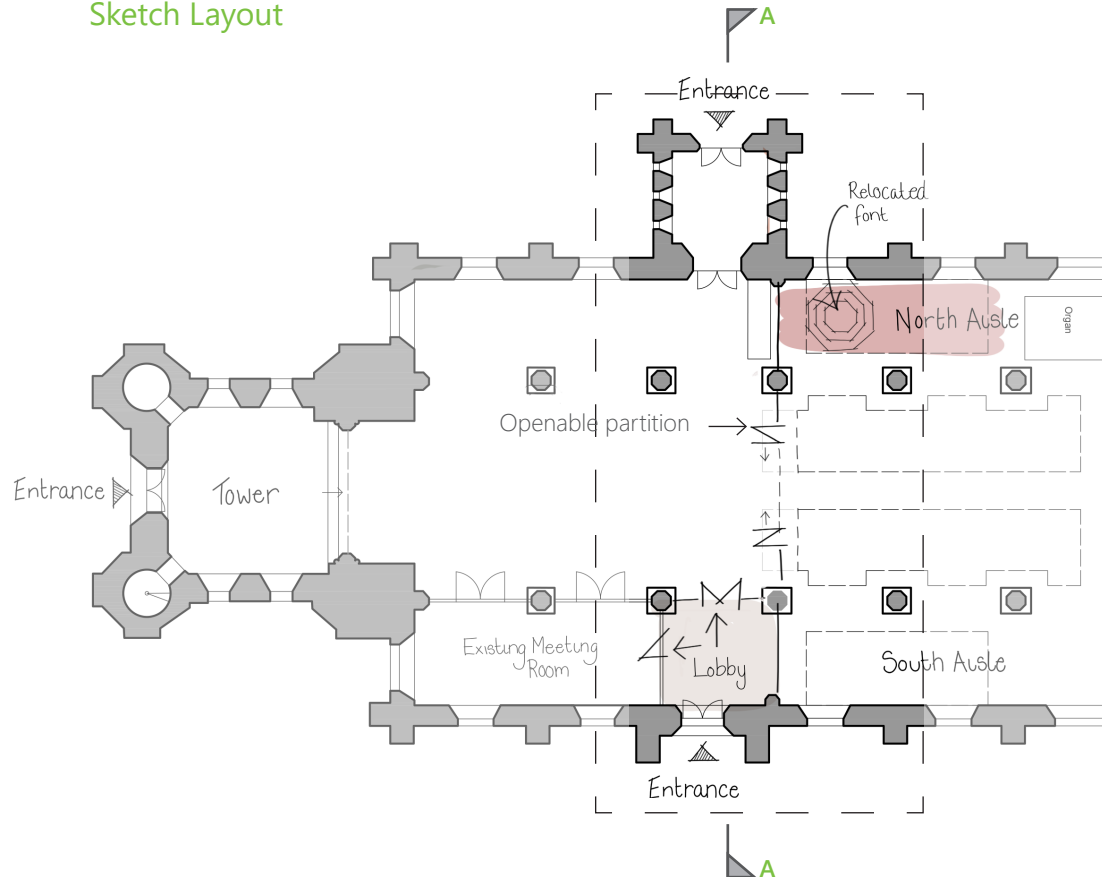

Section A - Looking towards Chancel

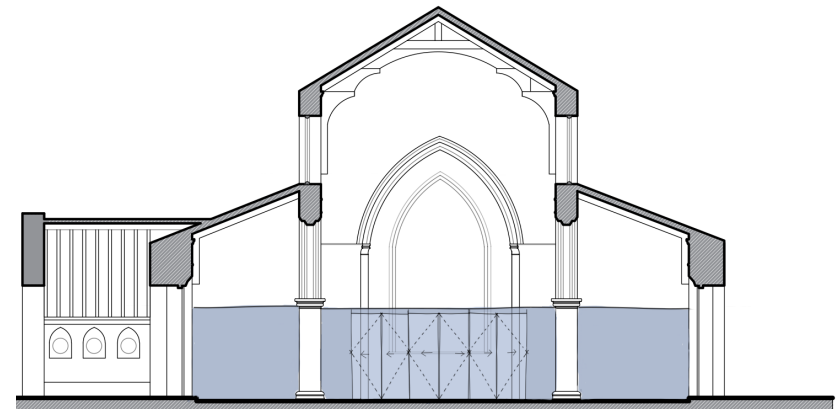

Initial Interventions

Summary

We have assumed the following additions and interventions for all of the initial options considered in this booklet:

- Relocation of the font from the west end of the church to the North Aisle worship space. This allows more flexibility to the central community space. Some pew removal would be required.
- Installation of a new, glazed lobby to the South door. This would help to mitigate heat loss within the church whilst allowing the external doors to remain open to welcome visitors and users to the church.
- Installation of an additional glazed door into the existing meeting room from the east of the space. This would allow the meeting room to be used at the same time as the central community space.
- Installation of a new separating partition east of the south door. When closed off, this would control access to the worship space for community users as required. One or two rows of pews would likely need to be removed.

Precedent Images



Holy Trinity Church, Sloane Square
Glass Meeting Rooms, Glass Doors



St Mary's Church
Structural Glass Screens, Frameless Glass Doors



St Marys church Kippington
Glass screen and ceiling panel porch

Option 1

Sketch Layout

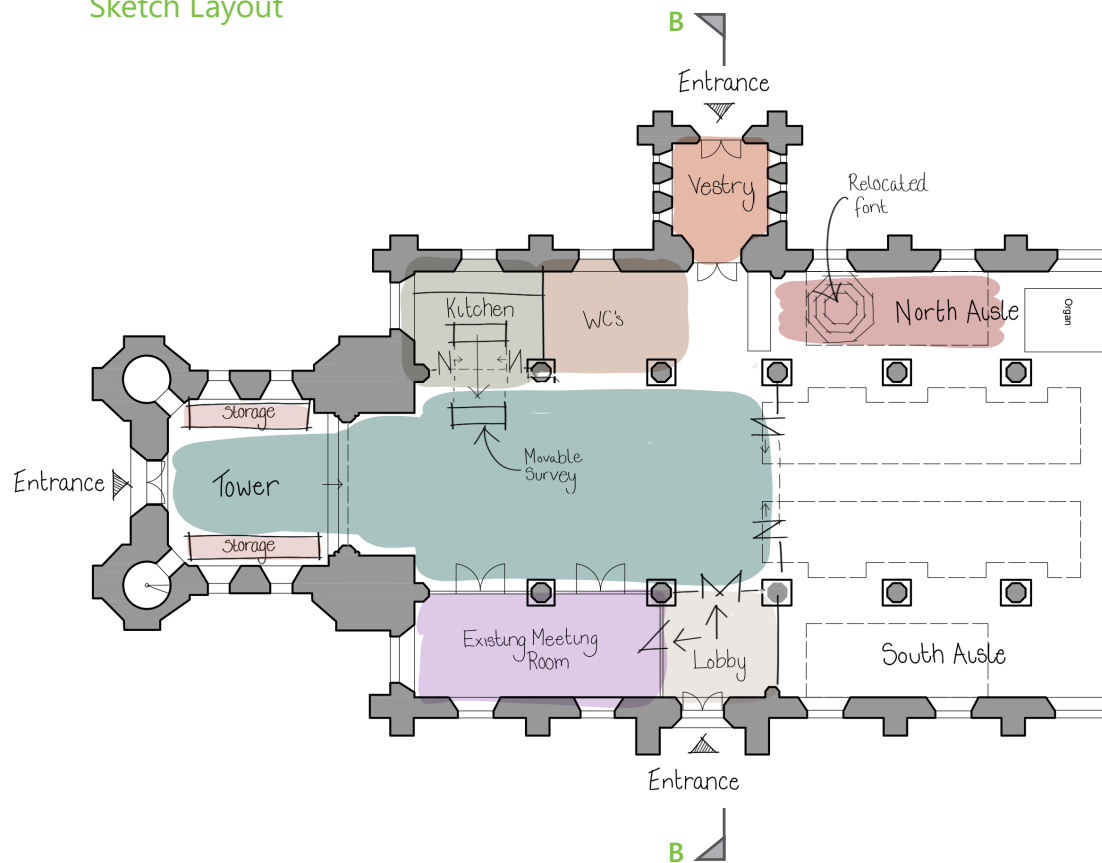

Section B - Looking towards Tower

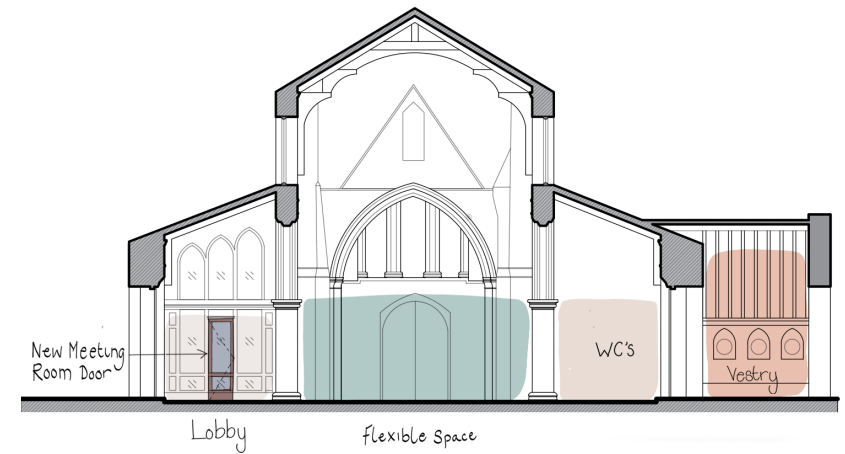

Key	
	Kitchen
	Vestry
	WC's
	Meeting Space
	Storage
	Flexible Space
	Relocated Font
	Lobby

Option 1

Summary

- Flexible kitchen space to North West corner which can be closed off or opened and moveable cupboard/worktop unit moved out as required.
- New WCs (exact No. TBC).
- Vestry/Office relocated to North Porch area.
- Additional storage to tower base.
- New internal glazed lobby to South door to help retain heat to church.
- New door into existing Meeting Room from the East to allow independent use from central space.
- Screen to worship area to provide separation of the worship space - This may require removal of 1 or 2 rows of pews.
- Relocation of font to North aisle with worship space to allow more flexibility to central community space.

Precedent Images



Flexible kitchen arrangements - secured when not in use.
All Saints' Melton Mowbray (above top)
St Mary Magdalene, Tanworth (above bottom)
St Michael and All Angels, Kingstone (right)



Option 2a

Sketch Layout

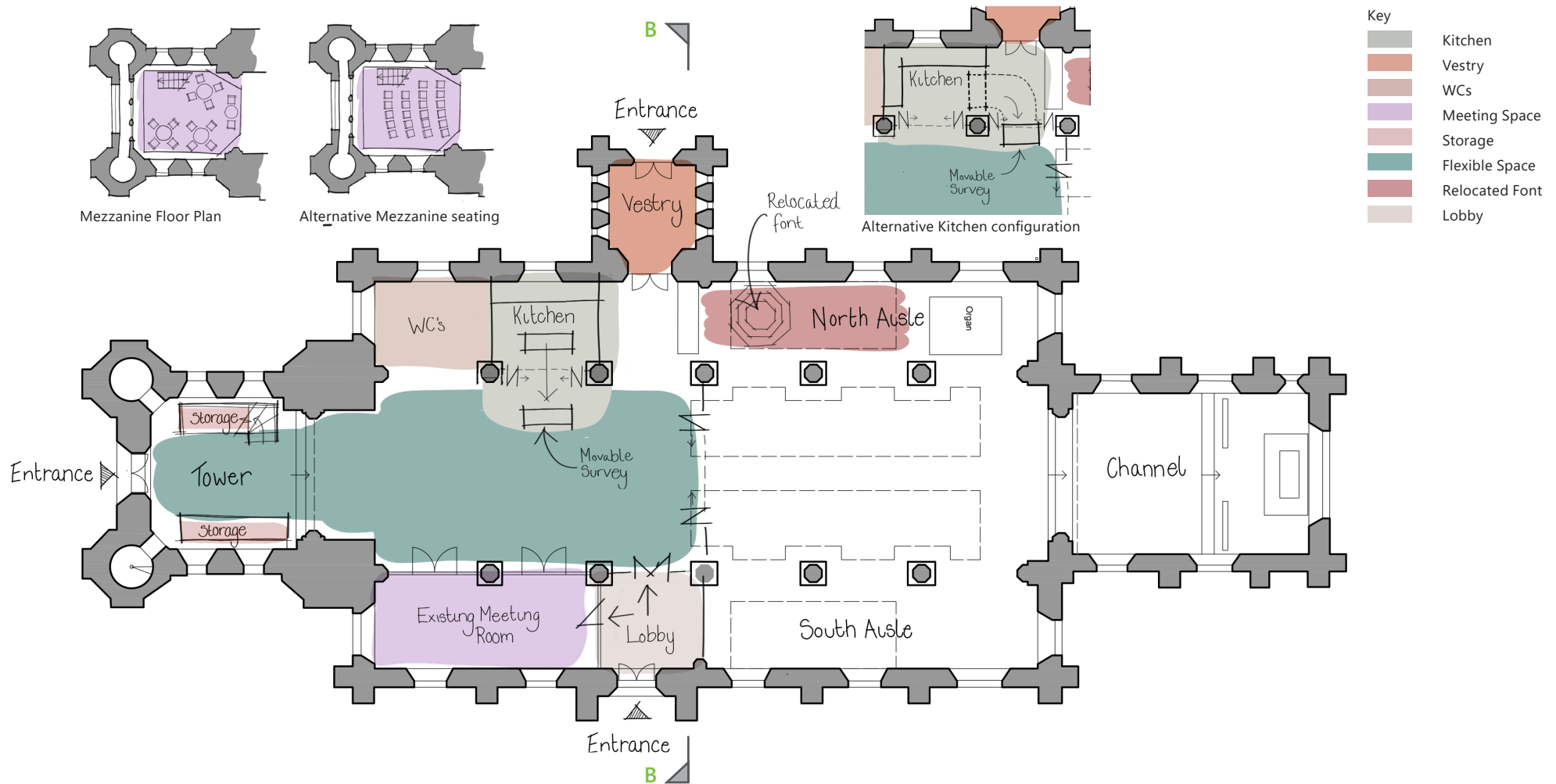

Option 2b

Sketch Layout

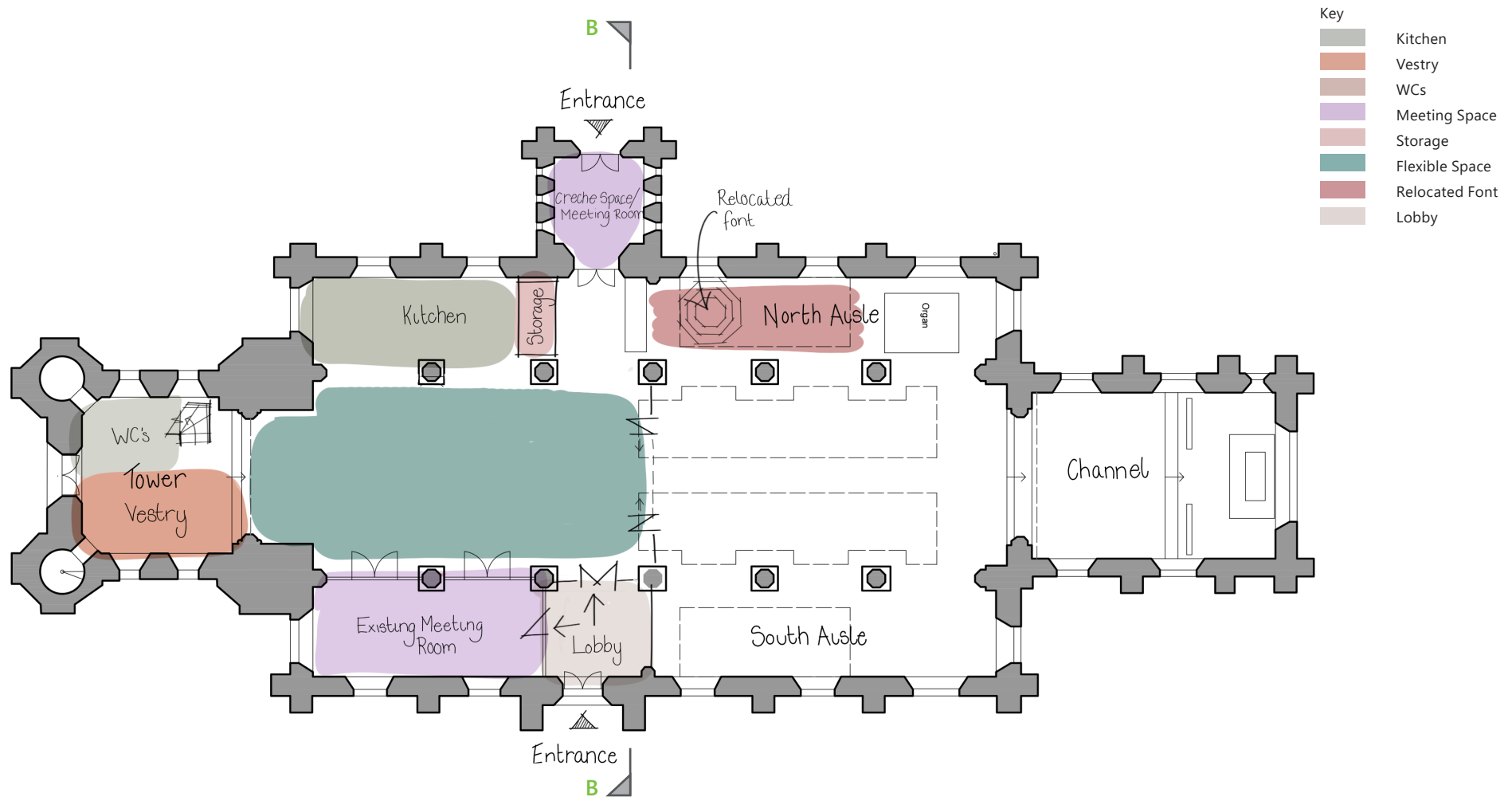

Option 2a

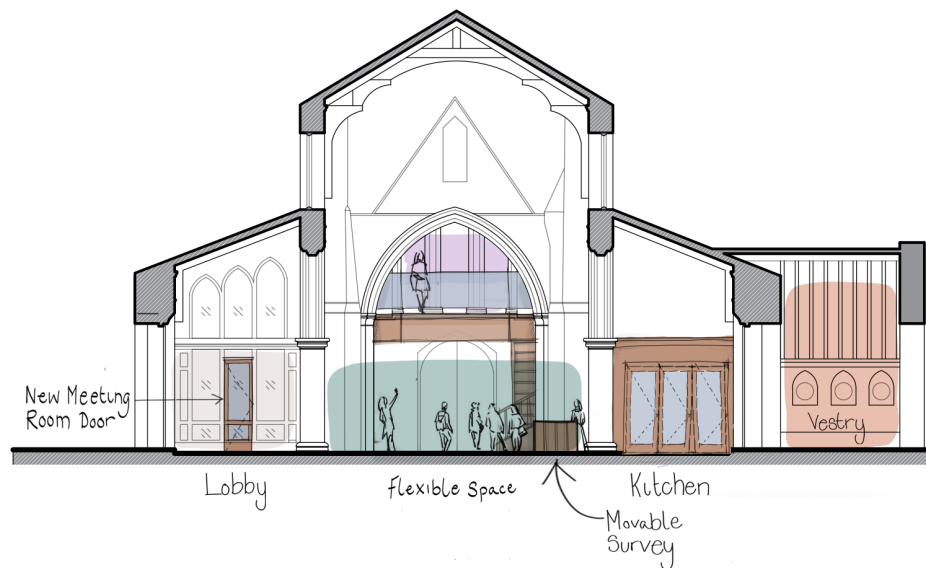

- Key**
- Kitchen
 - Vestry
 - WCs
 - Meeting Space
 - Storage
 - Flexible Space
 - Relocated Font
 - Lobby

All Saints' Church, Elm
Community Hub Initial Options

December 2024

Option 2b

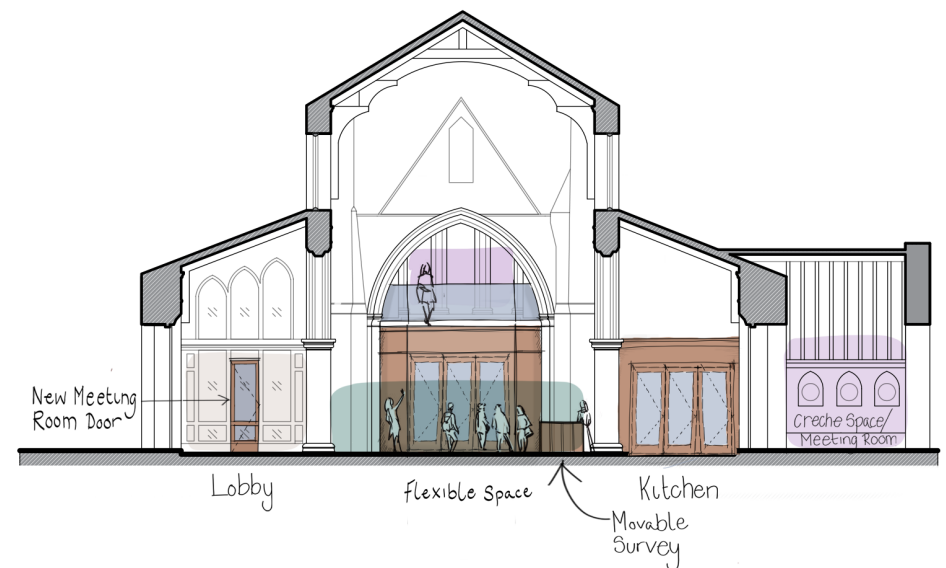

r h partnership architects

Option 2a & 2b

Summary

- Mezzanine floor inserted in base of Tower on same level as West Gallery/colonnade. Beneath this left mostly free to allow West doors to still be used.
- Option 2b to fill base of tower potentially with Vestry and/or some WCs if West door was not required to be in use. North Porch could then become additional meeting space/ small children's group/ creche space
- Larger kitchen space to North west corner - open feel and inviting for visitors and users
- new WCs (exact No. TBC).
- Vestry/Office relocated to North Porch area.
- Additional storage to tower base.
- New internal glazed lobby to South door to help retain heat to church.
- New door into existing Meeting Room from the East to allow independent use from central space.
- Screen to worship area to provide separation of the worship space - This may require removal of 1 or 2 rows of pews.
- Relocation of font to North aisle with worship space to allow more flexibility to central community space.

Precedent Images



Tower mezzanine examples.
All Saints' Longstanton (above)
Holy Trinity Balsham (right)



Option 3

Sketch Layout

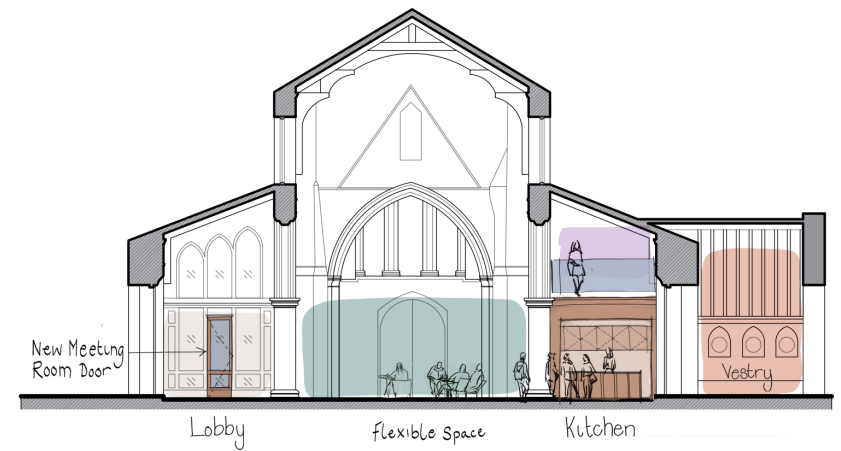
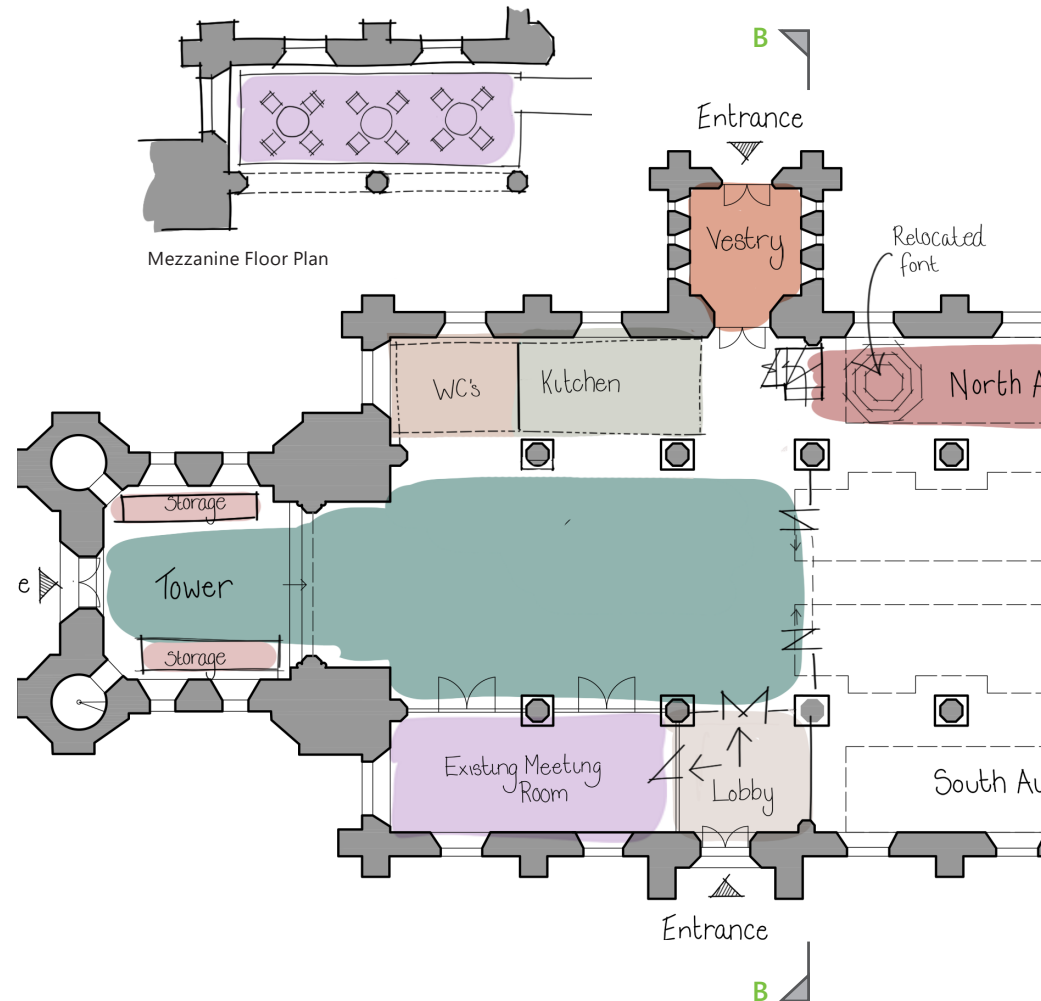

Key	
	Kitchen
	Vestry
	WCs
	Meeting Space
	Storage
	Flexible Space
	Relocated Font
	Lobby

Option 3

Summary

- Mezzanine floor to West end of the North Aisle to create meeting/ cafe style space.
- Larger kitchen space below new mezzanine- open feel so inviting for visitors and users
- New WCs (exact no. TBC).
- Vestry/Office relocated to North Porch area.
- Additional storage to tower base.
- New internal glazed lobby to South door to help retain heat to church.
- New door into existing Meeting Room from the East to allow independent use from central space.
- Screen to worship area to provide separation of the worship space - This may require removal of 1 or 2 rows of pews.
- Relocation of font to North aisle with worship space to allow more flexibility to central community space.

Precedent Images



Kitchens with mezzanines above.
All Saints' Hereford (above)
St Peter's, Peterchurch (right)



Flexibility of Space

Sketch Layouts

There are many opportunities for the central community space in the church. Here are a few possibilities of the flexibility of the space to spark your imagination:

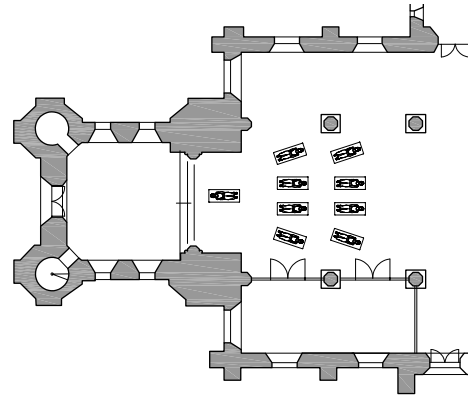

Fitness/ yoga class

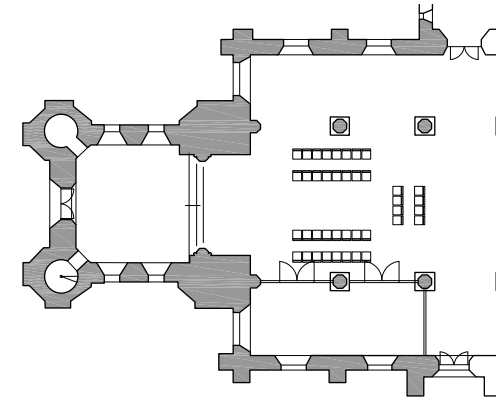

Meeting or small group layouts with groups of chairs

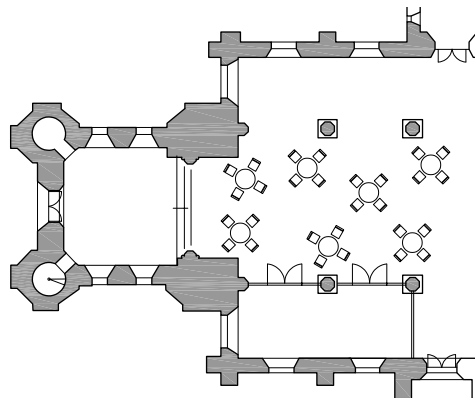

Cafe style layout with tables and chairs

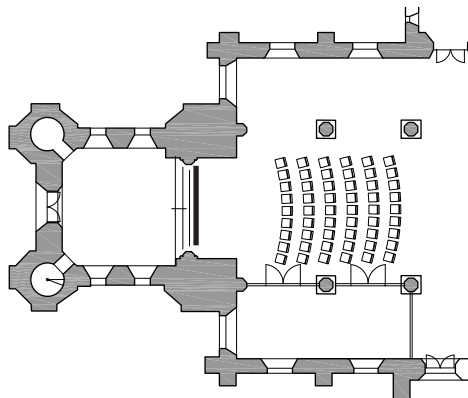

Film club or presentations

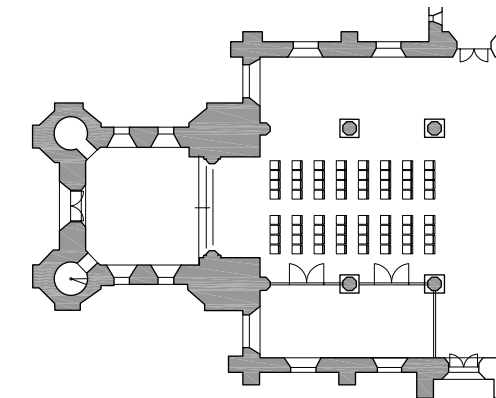

Performance space using the tower base as the stage area

Heating

Summary

Heating is a discussion to be had with specialist consultants. There are many options for a space of this height and volume and further analysis will be required in conjunction with a specialist to give initial options. Some possibilities are as follows:

Underfloor heating

Good for this type of space as people on the ground floor would get the benefit much quicker. Underfloor heating warms the objects and people in a space rather than the air meaning occupants would feel the benefit quicker than with regular convection heating. Underfloor heating would require more intervention than other types of heating but could also help regularise the floor and remove trip hazards to the west end. The installation of underfloor heating would require insulation under the floors and to the walls to allow for quicker warm-up times. It is found that a lower maintained temperature is more effective in heating the space than bursts of higher temperatures.

Heat Pumps

Underfloor heating could also be coupled with ground or air source heat pumps which could be installed during external ground works. This would allow for a renewable and self-functioning system rather than drawing electricity from the grid.

Infrared heating

Infrared heaters provide near instant heat. They work in a similar way to underfloor heating but are usually wall or ceiling mounted. They can also be very efficient and are often combined in lighting arrangements.



Precedent Images

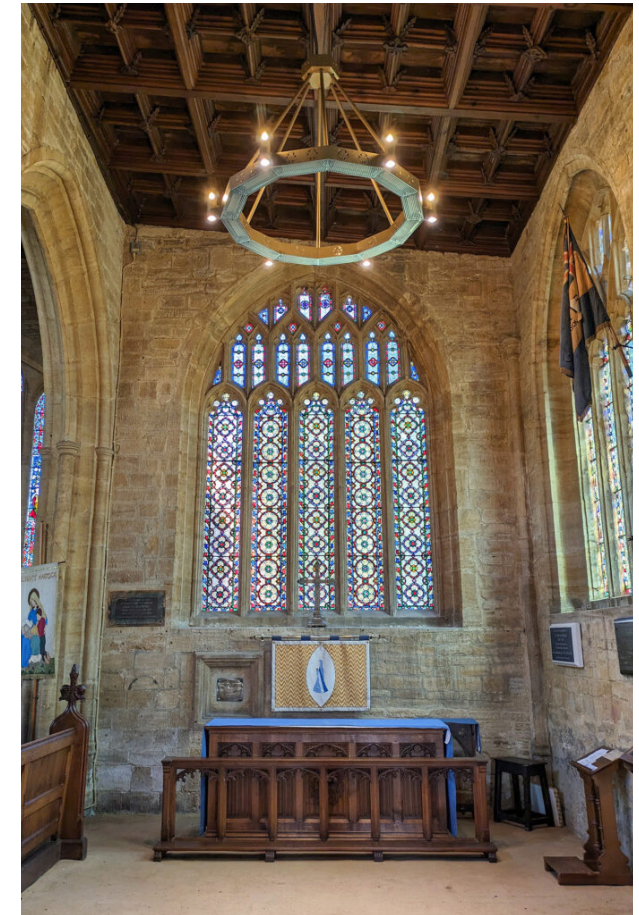

St Matthews Church, Bristol (left)
All Saints Church, Martock (above)

rh p